





Fin. 96 - Ø35

Ottone satinato opaco

Mat satin brass

Laiton satiné mat

Messing satiniert matt

Latón satinado mate

Mosiądz satynowy matowy



Fin. 60 - Ø30

Ottone bronzo opaco

Mat bronze

Laiton bronzé mat

Messing Bronze satiniert matt

Latón bronze opaco

Mosiądz brąz matowy

VIVIANA

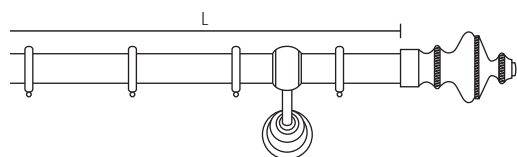

Scorritenda completo a parete
Complete curtain set
Tringle complète pose murale
Komplette Wandgarnitur
Conjunto completo a pared
Karnisz kompletny montaż do ściany

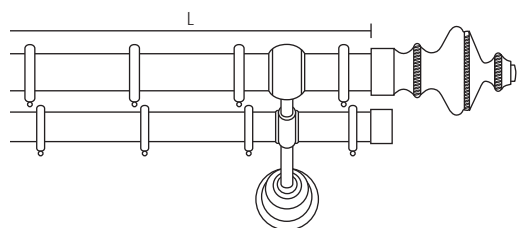

Scorritenda completo doppio a parete
Complete double curtain set
Tringle complète double pose murale
Komplette Doppelgarnitur
Conjunto completo doble a pared
Karnisz podwójny kompletny montaż do ściany

FIN. = Finitura - Finish - Finition - Fertigung - Acabado - Wykonczenie
An. = Anelli - Rings - Anneaux - Ringe - Anillas - Kółka
Sup. = Supporti - Brackets - Supports - Träger - Soportes - Wsporniki

Cod. 206A62		Ø 20 mm								
FIN	cm	120	140	160	180	200	220	250	300	340
01										
30 - 60 - 95 - 96										
An.	n.	12	14	16	18	20	22	26	30	34
Sup. cm 7 - 12	n.	2	2	2	2	2	3	3	3	3

Cod. 256A62		Ø 25 mm								
FIN	cm		140	160	180	200	220	250	300	340
01										
30 - 60 - 95 - 96										
An.	n.		14	16	18	20	22	26	30	34
Sup. cm 7 - 12	n.		2	2	2	2	3	3	3	3

Cod. 306A62		Ø 30 mm								
FIN	cm			160	180	200	220	250	300	340
01										
30 - 60 - 95 - 96										
An.	n.			16	18	20	22	26	30	34
Sup. cm 9 - 18	n.			2	2	2	3	3	3	3

Cod. 356A62		Ø 35 mm								
FIN	cm			160	180	200	220	250	300	340
01										
30 - 60 - 95 - 96										
An.	n.			16	18	20	22	26	30	34
Sup. cm 9 - 18	n.			2	2	2	3	3	3	3

Cod. 306C62		Ø 30/20 mm								
FIN	cm		160	180	200	220	250	300	340	
01										
30 - 60 - 95 - 96										
An.	n.			16/16	18/18	20/20	22/22	26/26	30/30	34/34
Sup. cm 9 - 18	n.			2	2	2	3	3	3	3

Cod. 356C62		Ø 35/20 mm								
FIN	cm		160	180	200	220	250	300	340	
01										
30 - 60 - 95 - 96										
An.	n.			16/16	18/18	20/20	22/22	26/26	30/30	34/34
Sup. cm 9 - 18	n.			2	2	2	3	3	3	3

Per maggiorazione movimento a corda vedi modello Ornella - For corded systems' price addition please see model Ornella
Pour supplément de prix pour tirage voir modèle Ornella - Zuschlag für Schnurbedienung auf die Ornella Seite
Por suplemento de precio por cuerda ver modelo Ornella
Aby zwiększyć ruchomość można zastosować karnisz ze sznurkiem - patrz model Ornella

VIVIANA

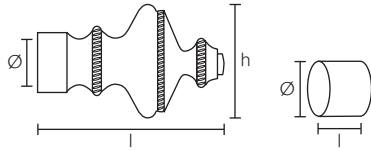

--6062

Terminale
Finial
Embout
Endstück
Terminal
Końcówka

--6045

Tappo
End cap
Bouchon
Endkappe
Tapón
Zatyczka

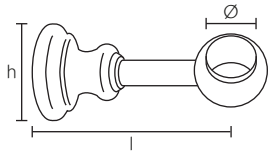

--6318 --6328

Supporto
Bracket
Support

Träger
Soporte
Wspornik

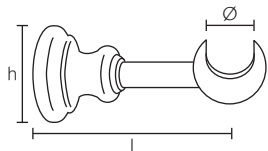

--6319 --6329

Supporto aperto
Open bracket
Support berceau

Offenträger
Soporte abierto
Wspornik otwarty

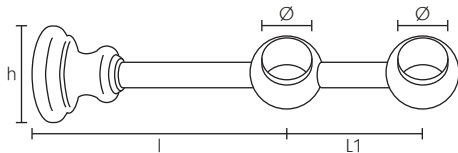

--6377 256337 356397

Supporto doppio
Double bracket
Support double

Doppelträger
Soporte doble
Wspornik podwójny

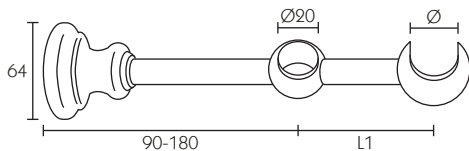

--6317

Supporto doppio
Double bracket
Support double

Doppelträger
Soporte doble
Wspornik podwójny

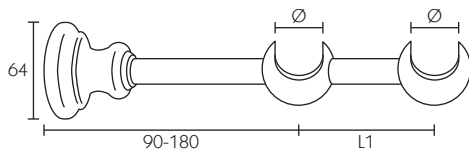

--6399 306327 356337

Supporto doppio
Double bracket
Support double

Doppelträger
Soporte doble
Wspornik podwójny

Cod.		206062	256062	306062	356062	206045	256045	306045	356045
FIN	Ø mm	20	25	30	35	20	25	30	35
	h - mm	44	52	70	70				
	l - mm	64	74	103	103	20	22	23	26
01									
30 - 60 - 95 - 96									

Cod.		206318	206328	256318	256328	306318	306328	356318	356328
FIN	Ø mm	20	20	25	25	30	30	35	35
	h - mm	50	50	50	50	64	64	64	64
	l - mm	70 - 120	70 - 240	70 - 120	70 - 240	90 - 180	90 - 250	90 - 180	90 - 250
01									
30 - 60 - 95 - 96									

Cod.		256319	256329	306319	306329	356319	356329
FIN	Ø mm	25	25	30	30	35	35
	h - mm	50	50	64	64	64	64
	l - mm	70 - 120	70 - 240	90 - 180	90 - 250	90 - 180	90 - 250
01							
30 - 60 - 95 - 96							

Cod.		206377	256337	306377	306387	356397
FIN	Ø mm	20/20	25/20	30/20	30/30	35/35
	l - mm	70 - 120	70 - 120	90 - 180	90 - 180	90 - 180
	L - mm	70	72	75	95	100
01						
30 - 60 - 95 - 96						

Cod.		306317	356317
FIN	Ø mm	30/20	35/20
	L1 - mm	95	100
01			
30 - 60 - 95 - 96			

Cod.		306399	356399	306327	356337
FIN	Ø mm	30/20	35/20	30/30	35/35
	L1 - mm	75	80	100	105
01					
30 - 60 - 95 - 96					

Components

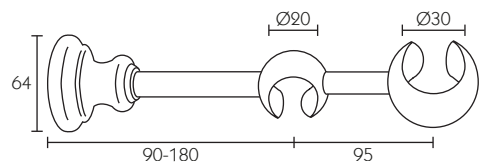

306347

Supporto doppio binario
Double bracket for rail
Support double pour rail

Doppelträger für Schiene
Soporte doble para riel
Wspornik otwarty

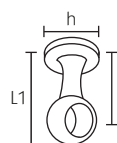

--6298

Supporto monoblocco
Monobloc bracket
Support monobloc

Einstückträger
Soporte monobloque
Wspornik monoblok

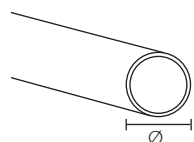

--6100

Tubo
Tube
Tube

Rohr
Tubo
Rura

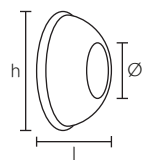

--5001

Rosetta a muro
Recess bracket
Naissance murale

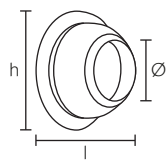

305001 305001

Wandlager
Soporte lateral
Podkładka do muru

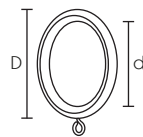

5260--

Anello con guarnizione ed occhio metallico
Ring with inlay and metal eyelet
Anneau avec joint et oeillet métallique
Ring mit Gleiteinlage und Metallöse
Anilla con guarnición y gancho metálico
Kółko z wkładką teflonową i uchwytem metalowym

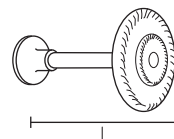

5160--

Fermatenda
Holdback
Porte-embrasse



5160--

Raffhalter
Alzapaño
Przytrzymanie franki

Cod.		306347
FIN	Ø mm	30/20
01		
30 - 60 - 95 - 96		

Cod.		206298	256298	306298
FIN	Ø mm	20	25	30
	h - mm	35	40	40
	l - mm	40	50	50
	L1 - mm	51	67	67
01				
30 - 60 - 95 - 96				

Cod.		206100	256100	306100	356100
FIN	Ø mm	20	25	30	35
01					
30 - 60 - 95 - 96					

Cod.		205001	255001	305001	355001
FIN	Ø mm	20	25	30	35
	h - mm	42	47	64	64
	l - mm	22	26	33	28
01					
30 - 60 - 95 - 96					

Cod.		526005	526004	526003
FIN	Ø mm	20	25	30/35
	D - mm	45	50	60
	d - mm	33	38	42
01				
30 - 60 - 95 - 96				

Cod.		516024	516025	516031	516076	516077
FIN	Ø mm				70	30
	l - mm	100	150	200		
01						
30 - 60 - 95 - 96						